

CHONGQING
ADORATION
TECHNOLOGY CO., LTD..



ADORATION

Injection Pump

Product Identifier

Product Name
Injection Pump

Description

Adoration Injection Pumps function as the core equipment for transferring epoxy, polyurethane, and acrylic resins into concrete structures. A modular dual- or single-component system is integrated to provide controlled and consistent material flow during injection operations.

Supplier Details

1-3, Mansion 6, 32#,
YuNan DaDao, BaNan District,
Chongqing, China

Uses

Adoration Injection Pumps function as the primary machinery for delivering resins and grouts into concrete structures. They are primarily used for controlled injection of epoxy, polyurethane, and acrylic materials, making them suitable for a wide range of applications. Their versatility allows use in crack repair, waterproofing, slab lifting, concrete jacking, structural reinforcement, concrete restoration, and curtain injection projects.

Emergency Phone Numbers

Call Adoration
Day or Night

+86 13983390012
023-63538530

Advantages

- A comprehensive range of Adoration Injection Pumps is available, including models for single- and dual-component injection.
- Different models are designed for various materials such as polyurethane, epoxy, and acrylic.
- Engineered to deliver precise flow and maintain consistent pressure, ensuring reliable and efficient performance during demanding injection operation.



Product Data

Form Types

Polyurethane Pump

Crack Repair/Waterproofing/Slab Lifting/Concrete Jacking

Polyurethane pumps are designed for high-performance injection applications. They are ideal for crack repair, waterproofing, slab lifting, and concrete jacking. Polyurethane foam can quickly expand and fill voids, stabilizing and lifting sunken concrete slabs while sealing cracks and preventing water infiltration. Its lightweight, flexible nature allows it to penetrate tight spaces, providing long-lasting durability and structural support.

Epoxy Pump (Structural Reinforcement / Two-Component 1:1, 1:2, or others)

Crack Repair/Waterproofing/Concrete Restore/Slab Lifting/Concrete Jacking

Epoxy pumps are used for structural reinforcement and high-precision two-component injections, available in ratios such as 1:1 or 1:2, or customized as needed. They are suitable for crack repair, waterproofing, concrete restoration, slab lifting, and concrete jacking. Epoxy resins provide excellent adhesion and high mechanical strength, making them ideal for strengthening damaged or weakened concrete structures, filling cracks, and restoring structural integrity.

Acrylic Pump

Waterproofing / Curtain Injection

Acrylic pumps are specialized for waterproofing and curtain injection applications. The acrylic material allows for easy penetration and sealing of cracks and joints, providing a flexible and effective barrier against water infiltration. Curtain injections using acrylic pumps are commonly applied in basement walls, tunnels, and other concrete structures to prevent water seepage and maintain long-term waterproofing performance.



Injection Pump

for Concrete Repair

Technical Data

Adoration SU-999	
Specification	SU-999 Single Element Injection Machine
Control	Hand on Drill
Configuration	Main Dual Gear box, Pressure Gauge 2pcs, Hose 5Mx2, Hopper 2pcs, Spare Kit, Drill
Max Pressure	Max Out put 15000 PSI, Hose Max Blast Pressure Endurance 10000Psi, Safe Range of the Switching Valve 18000 Psi
Pressure of Starting Again	≤10000Psi
Drill Power	910W/110V~220V
Hose Length	5M, Metal reinforced skin, silvery Color



Adoration DN-999	
Specification	DN-999 Dual Element Injection Machine 1:1 Epoxy or Polyurethane
Control	Hand on Drill
Configuration	Main Single Gear box, Pressure Guage 1pc, Hose 5Mx1, Hopper 1pc, Spare Kit, Drill
Max Pressure	Max Out Put 15000Psi, Hose Max Blast Pressure endurance 10000Psi, Safe Range of the Switching Valve 18000Psi
Pressure of Starting Again	≤10000Psi
Drill Power	1350W/110V~220V
Hose Length	5M, Metal reinforced skin silvery color



*DN-999 can be used for slab lifting.



Injection Pump

for Concrete Repair

Technical Data

Adoration DN-999 (L)	
Specification	DN-999 Dual Element Injection Machine 2:1 Epoxy or Polyurethane
Control	Hand on Drill
Configuration	Main Single Gear box, Pressure Guage 1pc, Hose 5Mx1, Hopper 1pc, Spare Kit, Drill
Max Pressure	Max Out Put 15000Psi, Hose Max Blast Pressure endurance 10000Psi, Safe Range of the Switching Valve 18000Ps
Pressure of Starting Again	≤10000Psi
Drill Power	1350W/110V~220V
Hose Length	5M, Metal reinforced skin silvery color



Adoration DR-999	
Specification	Remote DR-999 Dual Element Injection Machine 1:1 Epoxy or Polyurethane
Control	Wireless Remote Control
Configuration	Main Dual Gear box, Pressure Guage 2 pcs, Hose 5MX2, Hopper 2pcs, Spare Kit, Drill with Remote Control, Remote Controller 2pcs
Max Pressure	Max Out Put 15000Psi, Hose Max Blast Pressure endurance 10000Psi, Safe Range of the Switching Valve 18000Psi
Pressure of Starting Again	≤10000Psi
Drill Power	710W/110V~220V
Hose Length	5M, Metal reinforced skin silvery color



Injection Pump for Concrete Repair

Technical Data

Adoration DV-999	
Specification	DV-999 Ratio Adjustable Dual Element Injection Machine 1:1, 2:1, 3:1, 4:1,5:1 Epoxy or PU
Control	Hand on Motor
Configuration	Twin Gear boxes, Pressure Guage 1pc, Hose 5Mx1, Hopper 1pc, Spare Kit, Twin Motors, Ratio-Speed Converter
Max Pressure	Max Out Put 15000Psi, Hose Max Blast Pressure endurance 10000Psi, Safe Range of the Switching Valve 18000Psi
Pressure of Starting Again	≤10000Psi
Drill Power	1350W*2/110V~220V
Hose Length	5M, Metal reinforced skin silvery color



Adoration DA-999	
Specification	DA-999 Dual Element Acrylic Injection Machine
Control	Hand on Motor
Configuration	Main Dual Gear box, Pressure Guage 2pcs, Hose 5Mx2, Hopper 2pcs, Spare Kit, Motor With 5 Speeds Control
Max Pressure	Max Out Put 15000Psi, Hose Max Blast Pressure endurance 10000Psi, Safe Range of the Switching Valve 18000Psi
Pressure of Starting Again	≤10000Psi
Drill Power	1800W/110V~220V
Hose Length	5M, Metal reinforced skin silvery color



*DA-999 is designed for acrylic materials.



Injection Pump

for Concrete Repair

Application

READ CAREFULLY BEFORE USING INJECTION PUMP

General Information

The pump has undergone trial runs and pressure testing to guarantee top quality standards. You may notice slight traces of hydraulic oil inside the system or packaging, which is completely normal and will not affect its performance.

Getting Started

The pump comes ready for operation. To set up, screw the pressure hose into the front of the pump and secure it tightly. Insert the electric drill into the drill holder, then tighten the clamping ring until snug, but do not overtighten.

Caution

Please ensure that the black rubber grommets at the tops of the pressure gauges are pierced. The gauges are fluid-filled, so take care not to tip the unit over, as this may cause spillage of the liquid in the gauges. Use clockwise rotation setting on the drill only! Never pump water! Do not run the pump dry! The pump is now ready for operation! This pump may create very high injection pressures in excess of 6000 psi. Extremely high pressures can cause damage to attached hoses, valves, etc., and may also cause damage to the structure to be injected. Sudden ruptures or leaks in the delivery system may be hazardous to health and can cause injury or death. Make sure that the pump and attached hoses and fittings are connected tightly and are in as-new condition at any given time during operation. The equipment is designed for professional use only. Please observe caution at all times when operating this machine to avoid serious injuries.

Operation

For best results, use the electric drill provided with the pump. Do not use the drill in hammer-drill mode (if applicable). Begin the pumping process at a very low speed. If you are inexperienced with this type of injection pump, it is recommended to perform initial tests using hydraulic oil or resin without hardener to become familiar with handling the machine. Once the desired working pressure is reached, adjust the dial switch on the electronic drill to ensure the pressure is not exceeded. During regular injection, the pressure should remain well below 400 bar. Follow the resin supplier's instructions carefully. Ensure that no foreign particles enter the pump with the resin, as this will help extend the service life of the pump.



DN-999 (L)

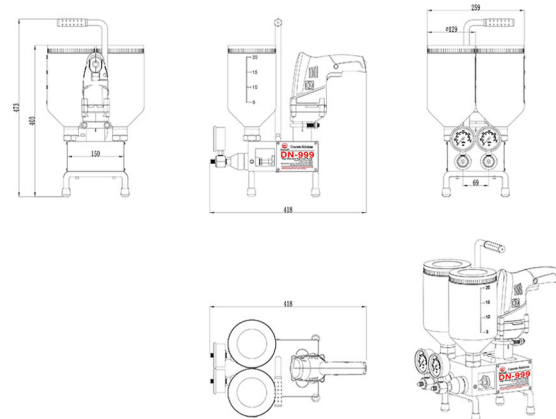

DN-999

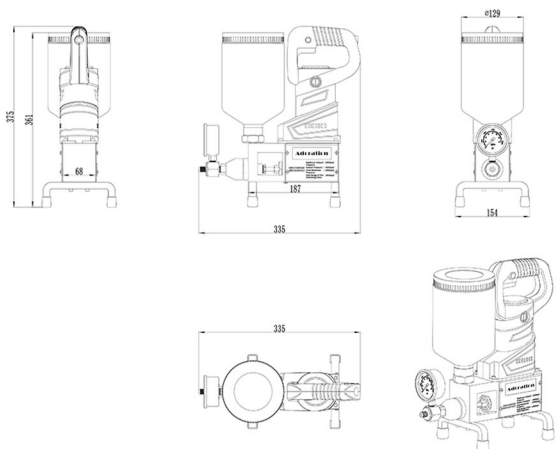

SU-999



zhouyu@adoration-tech.com
Adoration www.adoration-tech.com

Injection Pump

for Concrete Repair

Application

READ CAREFULLY BEFORE USING INJECTION PUMP

Safety Instruction

Personal Protection During Operation

Always follow the product data sheets and MSDS instructions.

Wear protective goggles.

Wear protective gloves while handling the pump.

Maintenance / Cleaning Tips

It is recommended to purge the pump of catalyzed PU before any break longer than 20 minutes, paying attention to the material's reaction time and never leaving mixed material in the pump beyond its pot life. After injection, purge the hoppers and lines of all activated material. Hydroactive polyurethanes may form a small cured "skin" on top of the batch; remove this with gloves and goggles before it reaches the filter, then refill the hopper with fresh material. Once purged, clean the pump using a solvent flush to remove cured polymer and lubricate the seals and piston. Run solvent through the pump, discard all remnants, close the shut-off valve, rebuild pressure, and relieve it with slow open/close movements. This creates a pressurized "rocking" flow that helps remove polymer from the hose walls. After flushing, the pump can be stored until next use.



Value Base

All technical specifications presented in this Product Data Sheet originate from controlled laboratory testing. Actual results may differ due to variables outside of our influence.

Local Restrictions

Please be advised that due to specific local regulations, the performance of this product may vary between countries. For an accurate description of the application areas, please refer to the Product Data Sheet applicable in your region.

Health and Safety Information

For guidance on the safe handling, storage, and disposal of chemical products, users should consult the latest Material Safety Data Sheet (MSDS), which includes information on physical properties, environmental impact, toxicology, and other safety considerations.

Legal Notes

The guidance provided concerning the use and application of Adoration products is offered in good faith, based on Adoration's current expertise and knowledge when the products are properly stored and handled. These recommendations do not constitute any express or implied warranty, including merchantability, nor do they establish any contractual or legal obligations. Adoration retains the right to update or modify its products at any time, while respecting third-party intellectual property rights. All purchases are subject to Adoration's standard terms of sale and delivery. Customers are advised to always refer to the most current version of the local Product Data Sheet, which is available upon request.